

MAKING ROOM FOR GILLY

To re-qualify the Place Destrée means to take in consideration the complexity and potential qualities of the site. Turning them into a strong urban experience means to define a strategy able to evolve and be adapted in time - an urban strategy that strongly and directly transforms the uses of the site while preparing the ground for its ambitious future configuration.

We propose to structure the urban process around 5 principles:

EMPTYING: A wide urban room for Gilly, as the first step for an ambitious urban renewal.

DEFINING: The project proposes to redefine the relation between the square and the surrounding buildings in order to activate its urban condition and shape.

PROCESSING/REUSING: Despite the actual lack of quality of the sport complex buildings, the existing layering logic is seen as an opportunity to develop a flexible building process able to define a characteristic public space. This evolutive process allows a site transformation in time and need.

CONNECTING: the public space and landscape logics of the site are extended, creating a continuous promenade under trees punctuated by public space interventions.

SHARED REFINING: The process for the redevelopment of the Place Destrée neighborhood acts as an urban vision defined by clear principles able to produce strong yet adapted changes. More than defining an agenda for a design, we propose a development logic that settles the basis for a shared refining between the city, the citizens, the developers and the planners.

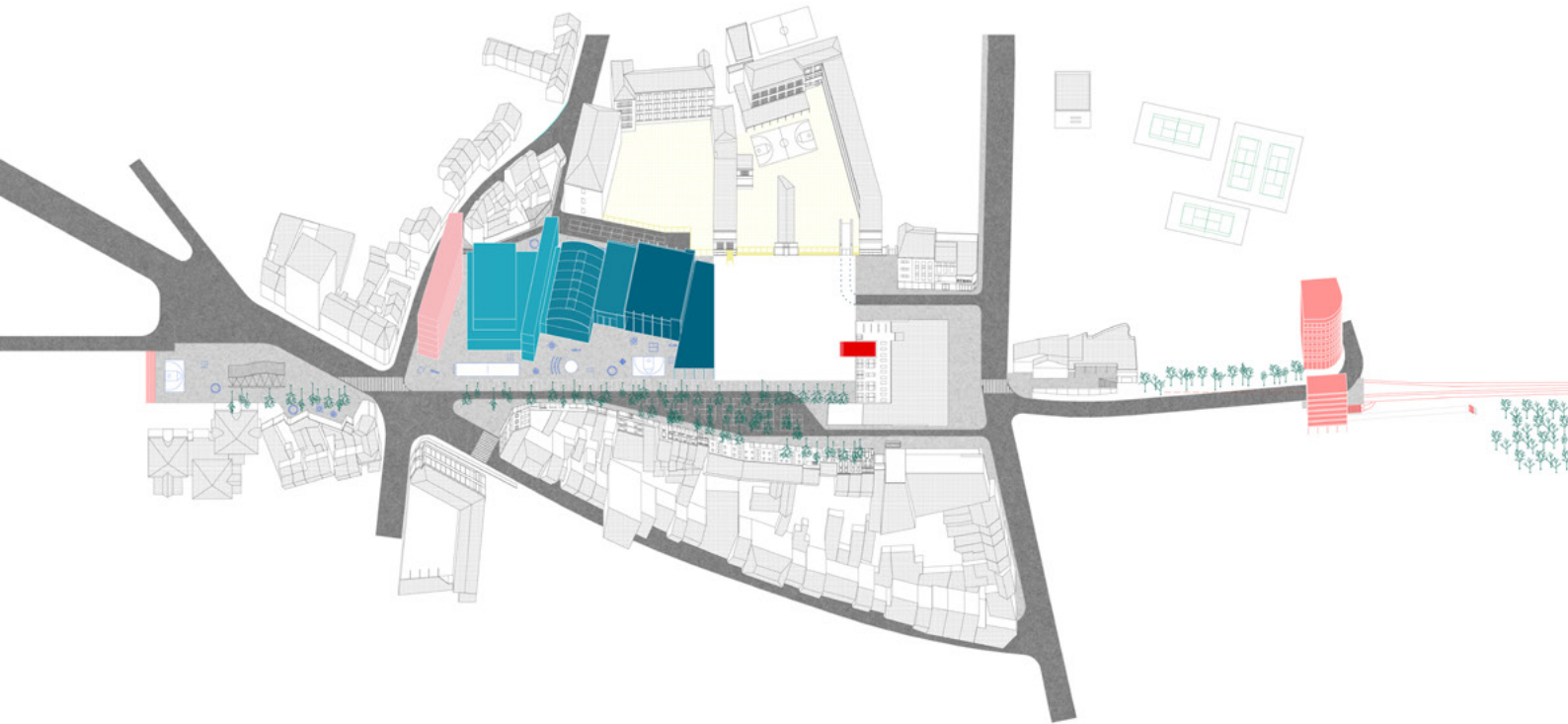

EMPTYING

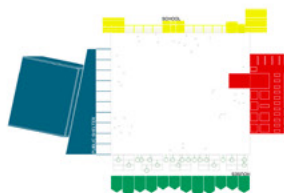

DEFINING



PROCESSING/REUSING
CONNECTING
SHARED REFINING

FLUX ORGANISATION



PUBLIC SPACE STRATEGY



PROGRAM



PUNCTUAL INTERVENTIONS

COMMON ROOF	LAYER LOGIC STRATEGY	REFRESHING - OPENING UP - LINKING	REFRESHING - OPENING UP - LINKING	OPENING UP TO THE SQUARE	REDEFINING GROUND FLOOR ADDRESSING TO THE SQUARE	CONNECTING TO THE PUBLIC LOGIC	A CONNECTED BELVEDERE
CONNECTING TO THE PUBLIC LOGIC	COVERED MARKET	EVENT PLACE	A PUBLIC SHELTER	1 TREE FOR 2 PARKINGS	OPENING UP TO THE PLACE DESTREÉE		

URBAN RENEWAL STRATEGY

DEFINING. Today, the school complex, the swimming pool, the town hall and the dwellings are surrounding a potential square without interacting with it. The project proposes to redefine the relation between the square and the buildings in order to activate its urban condition and shape.

PROCESSING/REUSING. The former swimming pool, the existing sport facilities, the youth centre and senior citizens centre function as a layered building complex. The southern and northern public spaces are leftovers from this accumulative logic. Despite the actual lack of quality, the layering logic is seen as an opportunity to develop a flexible building process able to define a characteristic public space. This flexible process is reclaim to allow a site transformation in time and need. New programs are inserted when former, no longer appropriated buildings are removed.

Therefore we propose a scenario of a building complex defined by layers. A canopy related to the square on the eastern side and a housing building on the western, in between we propose to slightly renovate the existing sport facilities by opening them to the public space and to complete them by new, more adapted, sport structures and socially directed programs.

This complex also organizes the urban parours. On the north, the functional access with a kiss and ride, on the south, a programmed strip with sport facilities and playgrounds on which all the public functions are connected, the third inside promenade is set up to connect all the public facilities of the building.

CONNECTING. A connection between the Gazomètre metro station and the belvedere of the 'Impasse du Major' is reinforced. The public space and landscape logics of the site are extended, creating a continuous promenade under trees punctuated by public space interventions.

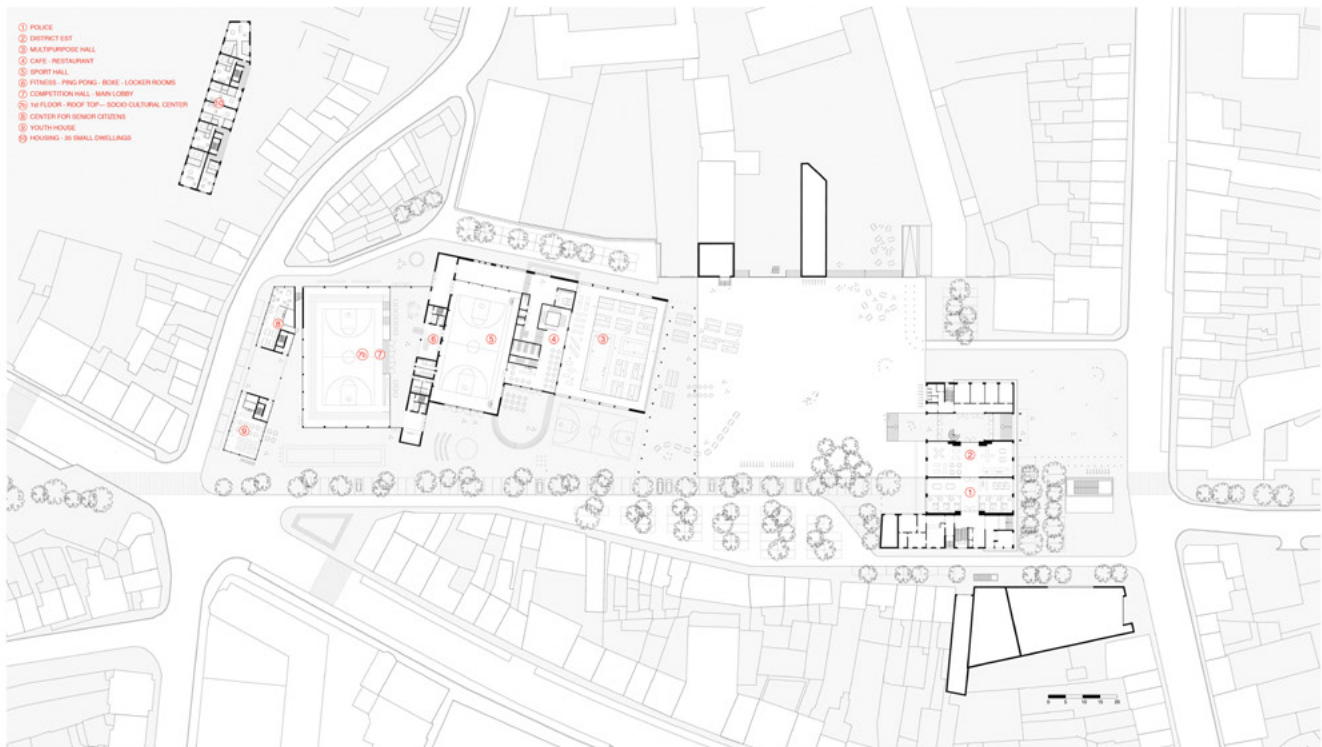

KU317

