



THE HETEROTOPIA POOL

THE HETEROTOPIA POOL

The Heterotopia Pool holds all culture, all real, which is simultaneously mythic and real. It links every fragmental sites, changes the functions within a single form, bridges the twisted and broken time and space under varying historical circumstances.

History

Like the City of Charleroi, the reality at Gilly is a mixture out of the historical scenes. During the last thousand years, it gradually developed itself as a kind of self-evident processes.

Around 1000 year, the natural landscape - Plateau, valleys, Steams contribute the evolution of the agriculture and forestry.

With the 700 years' development, Gilly became a farming village formed by the Church and the inhabitants.

Around 17th century, mining was the essential activity in the Gilly with the requirements of the Industrial Revolution.

The overlapping of different periods brings a rich but unclear situation.

Situation

But with the dying of the mining industry, there is no self-evident activity happening like the historical periods. The left city space became the mixture, the mist, the mystery.

Strategies

Form a simple void to have a clear spacial identity

The pool with a 235m x 32.5m platform, an underground car park, a linear service rooms, and an observation tower can hold all culture, sport, social activities which can be easily changed by the scales, the seasons.

Link the void with the nature and artificial landscape

The pool is located with the same level as the east landscape which bring a lot of benefits to link the existing surrounding public facilities.

Generate the net of public circulation

The net was supported to connect the whole area.

The Pool.
The Heterotopia.

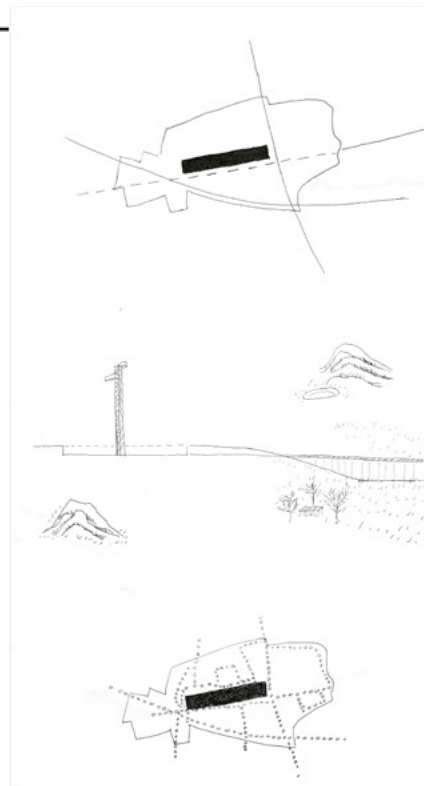

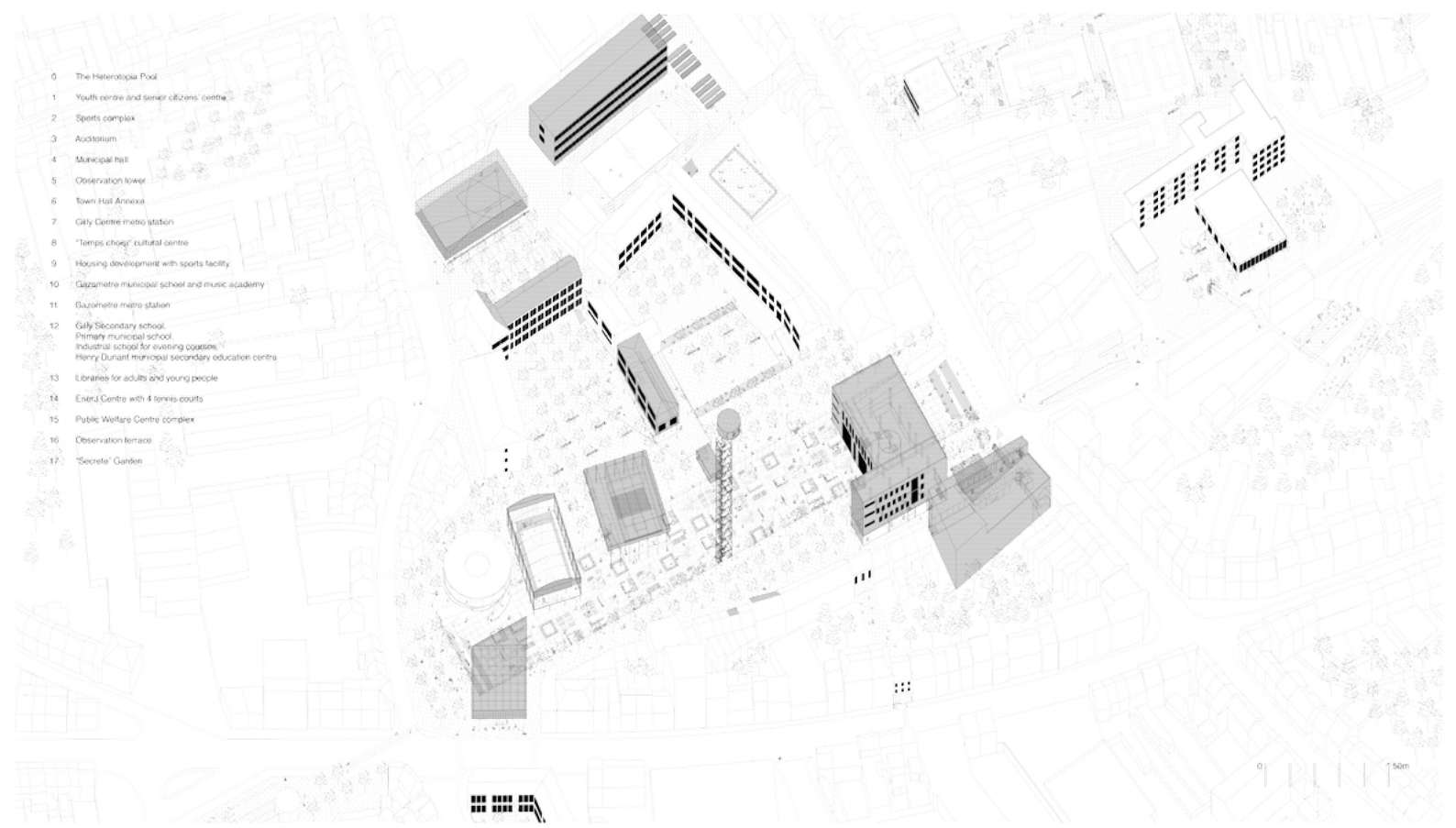



- 0 The Heterotopia Pool
- 0a Car park, 203 places
- 0b Service rooms for the Heterotopia Pool
- 1 Youth centre and senior citizens' centre
- 2 Sports complex
- 3 Auditorium
- 4 Municipal hall
- 5 Observation tower
- 6 Town Hall Annex
- 6a Entrance counter
- 6b Offices for the Municipal Police, public accessible
- 6c Archives and storage for the Town Hall
- 7 City Centre metro station
- 7a Entrance City Centre metro station
- 7b Platform City Centre metro station
- 7c Bus station
- 8 "Temps choisi" cultural centre
- 8a New entrance for "Temps choisi" cultural centre
- 8b Square for "Temps choisi" cultural centre
- 8c New roof terrace for "Temps choisi" cultural centre
- 9 Housing development with an interior gym and exterior sports facility

